

### DYNAMIS

#### LITHIUM-LINE

**LI-110/T (ER14250, 1/2 AA)**

**Order No. 60.08171**

Lithium Thionyl Chloride Cell



#### Electrical characteristics

(typical values for cells stored for one year or less at +25°C max.)

Nominal capacity at 1,0 mA with 2,0 V cut off voltage (25 °C). The capacity restored by the cell varies according to current drain, temperature and cut off voltage).	1,2 Ah
Nominal voltage	3,6 V
Max. recommended continuous current (To get 50 % of nominal capacity at +25°C with 2,0 V cut off.. For use with higher currents please contact DYNAMIS)	40 mA
Pulse capability Typically up to 100mA / 0,1 second pulses, drained every 2 min. (25°C) from undischarged cells with 10 µA base current, yield voltage readings above 3,0 V. (The readings may vary according to the pulse characteristics, temperature, and the cell's previous history. Fitting cell with a capacitor is recommended in severe conditions application)	100 mA
Storage temperature (recommended, according other demands contact DYNAMIS)	+30°C max.
Operating temperature range (Operation at temperature different from ambient may lead to reduced capacity and lower voltage plateau readings.)	-55°C ~ +85°C

#### Physical characteristics

Height (max.)	25,4 mm
Diameter Ø (max.)	14,5 mm
Typical weight	10 g

UL certified

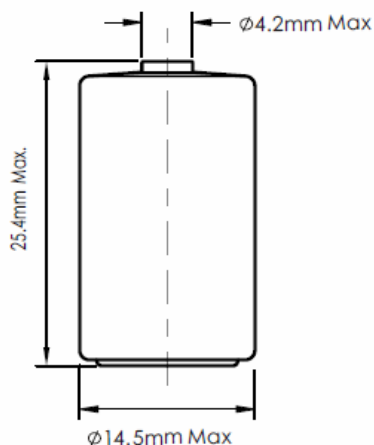

Pin configuration: Tabs T

1/2 AA	7±0.5
2/3 AA	7±0.5
AA	7±0.5
C	16 <sup>+1</sup> <sub>-2</sub>
D	12 <sup>+1</sup> <sub>-2</sub>
DD	12 <sup>+1</sup> <sub>-2</sub>

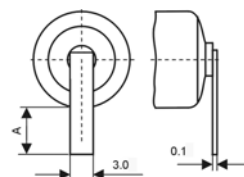

### Key features

- High and stable operating voltage
- High minimum voltage during pulse application
- Low self discharge rate (less than 1 % after 1 year of storage at +25°C)
- Stainless steel container
- Hermetic glass-to-metal sealing
- Non-flammable electrolyte

### Warning

- Fire, explosion and severe burn hazard.
- Do not recharge, crush, disassemble, heat over 100°C or incinerate.
- Do not expose cell or contents to water

### Main applications

Utility metering  
 Alarms and security devices  
 Memory back-up  
 Tracking systems  
 Automotive electronics  
 Professional electronics etc.

### Terminal variations

60.08170 standard (/S)  
 60.08171 solder tabs (/T)  
 60.08172 axial pins (/P)  
 60.08173 pins +(1)/-(2) (/PT)  
 60.08174 pins +(1)/-(1) (/EPR)

For other terminals please contact  
 DYNAMIS

### Compliance with Safety Standards

IEC 60086-4  
 EN 50020

The information (subject to change without notice) contained in this document is for reference only and should not be used as a basis for product guaranty or warranty. For applications other than those described here, please consult your nearest DYNAMIS Sales or Marketing Office or Distributors

Continuous Discharges at 25 °C (77 °F)

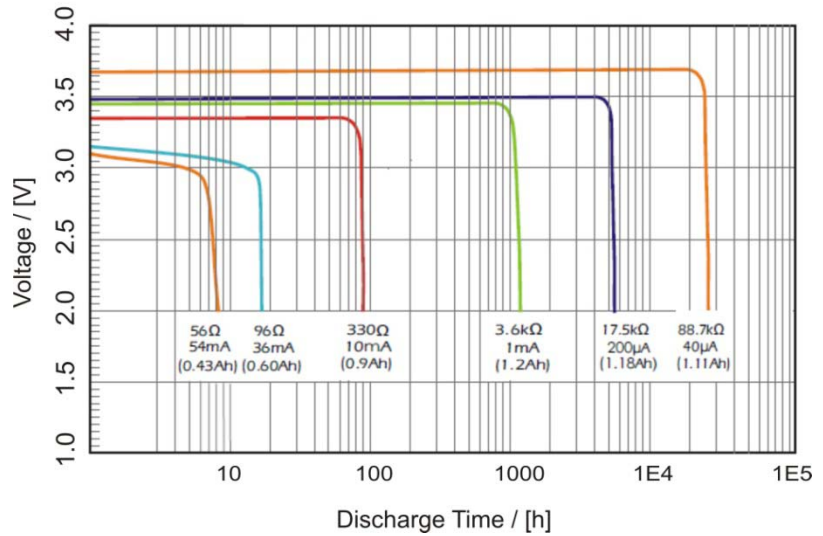

Voltage Levels at various Temperatures and Drain Conditions

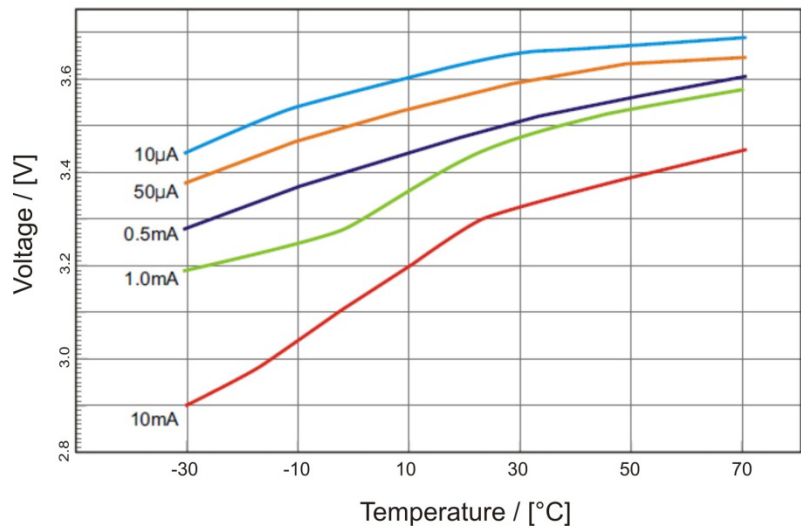

Temperature characteristics

