

### DYNAMIS

#### LITHIUM-LINE

**LI-130/T AA-size (ER14505)**

**Order no. 60.08181**

Lithium Thionyl Chloride Cell



#### Electrical characteristics

(typical values for cells stored for one year or less at +25°C max.)

Nominal capacity at 2,0 mA with 2,0V cut off voltage (25 °C). Cell capacity varies according to current drain, temperature and cut off voltage).	2,6 Ah
Typical capacity at 440 Ω (approx. 8.5 mA) with 3,0 V cut-off voltage (25 °C)	2300 mAh
Nominal voltage	3,6 V
Max. recommended continuous current (approx. 50 % of nominal capacity with 2,0 V cut off voltage (25 °C). For use with higher currents please contact DYNAMIS)	100 mA
Pulse capability Typically 0,1 second pulses, drained every 2 min. (25°C); from undischarged cells with 10 μA base current, yield voltage readings above 3,0 V.  (The readings may vary according to the pulse characteristics, temperature, and the cell's previous history. Fitting cell with a capacitor is recommended for heavy duty application)	200 mA
Storage temperature (recommended, according other demands contact DYNAMIS)	+30°C max.
Operating temperature range (Operation at temperature different from ambient may lead to reduced capacity and lower voltage plateau readings.)	-55°C ~ +85°C

#### Physical characteristics

Height (max.)	50,5 mm
Diameter Ø (max.)	14,5 mm
Typical weight	19 g

UL certified

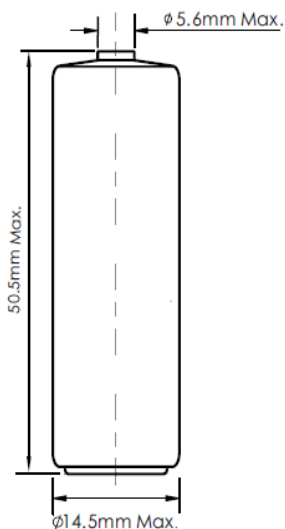

Pin configuration: Tabs T

1/2 AA	7±0.5
2/3 AA	7±0.5
AA	7±0.5
C	16 <sup>+1</sup> <sub>-2</sub>
D	12 <sup>+1</sup> <sub>-2</sub>
DD	12 <sup>+1</sup> <sub>-2</sub>

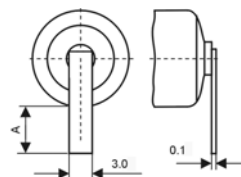

### Key features

- High and widely stable operating voltage
- High minimum voltage during pulse application
- Low self discharge rate (less than 1 % after 1 year of storage at +25°C)
- Stainless steel container
- Hermetic glass-to-metal sealing
- Non-flammable electrolyte

### Warning

- Fire, explosion and severe burn hazard.
- Do not recharge, crush, disassemble, heat over 100°C or incinerate
- Do not expose cell or contents to water

### Main applications

Utility metering  
Alarms and security devices  
Memory back-up  
Tracking systems  
Automotive electronics  
Professional electronics etc.

### Terminal variations

60.08180 standard (/S)  
60.08181 solder tabs (/T)  
60.08182 axial pins (/P)  
60.08187 pins +(1)/-(2) (/PT)

For other terminals please contact  
DYNAMIS

### Compliance with Safety Standards

IEC 60086-4  
EN 50020

Continuous Discharges at 25 °C (77 °F)

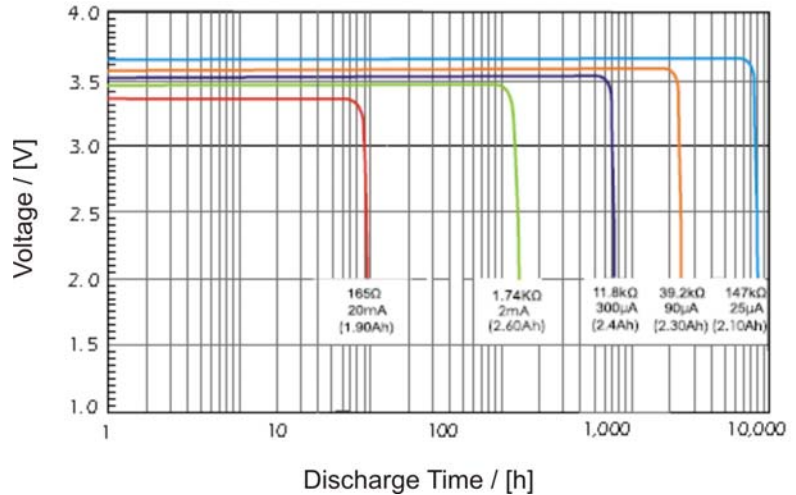

Voltage Levels at various Temperatures and drain conditions

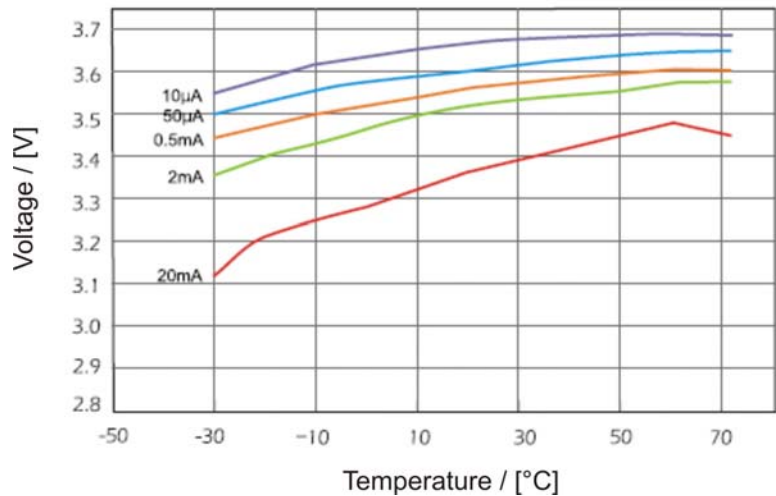

Temperature characteristics

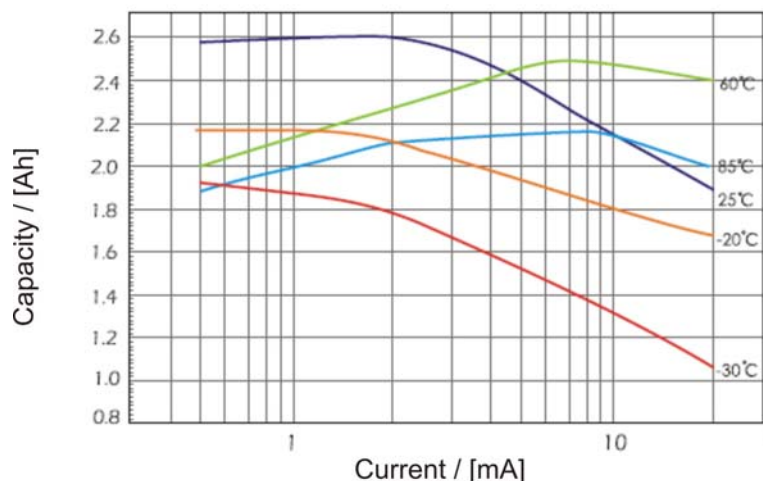

\* The information (subject to change without notice) contained in this document is for reference only and should not be used as a basis for product guaranty or warranty. For applications other than those described here, please consult your nearest DYNAMIS Sales or Marketing Office or Distributors.